

Package Content

Your Faucet Control™ Includes:

Control Module	Plastic Wire Staples
Foot Pedal	Mounting Screws (2)
Power Supply	Installation and Operating Instructions

Compatibility

Faucet Control™ is compatible with all residential faucets with or without pullout sprayers, excluding infrared hands-free faucets.

Installation – General

Please read all instructions before attempting installation.

Supply lines are not included with your Faucet Control™ since the required lengths and supply stop fitting diameters vary by installation. Flexible supply lines and 3/8" compression unions, if required, are available at home improvement stores.

Step 1 – Determining Faucet Connection Type

Faucets can be divided into two general categories based on the size and type of the faucet inlet fittings. Use the following descriptions together with Figures 1A and 1B to determine the connection type:

Option A

Faucets with 1/2" Male Connectors

Most residential faucets have inlet ports with 1/2" male connectors. The outside diameter of 1/2" straight pipe male thread is 27/32" (the same as the control module's inlet and outlet ports).

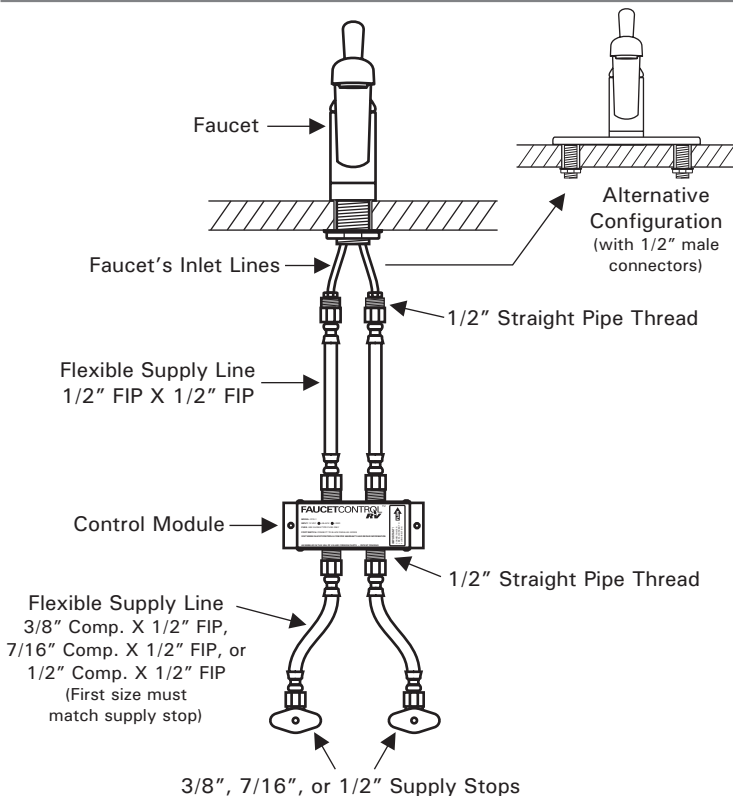

Figure 1A - Faucet with 1/2" Male Connectors

Step 1 – Continued

Option B

Faucets with 3/8" Female Compression Connectors

Some modern faucets come with integrated flexible inlet lines which have 3/8" female compression fittings. These flexible inlet lines are permanently connected to the faucet and have hex nut fittings with a typical head/wrench diameter of 5/8".

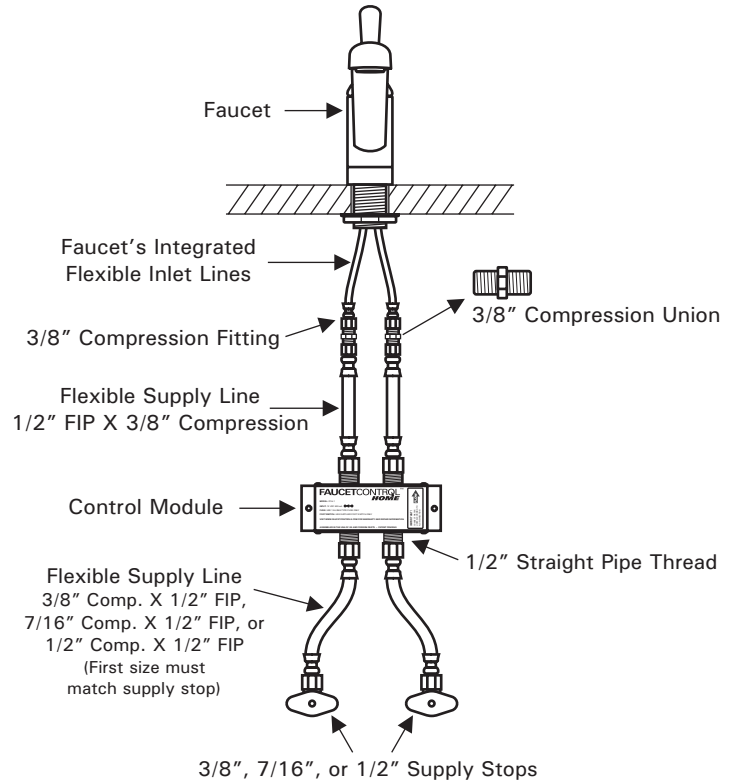

Figure 1B - Faucet with 3/8" Female Compression Connectors

Step 2 – Determining Supply Line/Fitting Needs

Option A

Faucets with 1/2" Male Connectors

If your current installation has **Flexible Supply Lines**, you may be able to disconnect them from your faucet and reconnect them to the control module's inlet ports. In this case, you will only need to purchase two flexible supply lines with 1/2" FIP connectors at both ends. These supply lines will connect the control module to your faucet.

If your current installation has **Rigid Supply Lines**, you will need to purchase two pairs of flexible supply lines. The first pair must have a connector that fits your supply stop (usually 3/8" compression) and a 1/2" FIP connector at the opposing end to fit the control module's inlet port. The second pair, which will connect the control module to your faucet, requires 1/2" FIP connectors at both ends.

(Option B is on the next page)

Step 2 – Determining Supply Line/Fitting Needs

Option B

Faucets with 3/8" Female Compression Connectors

You will need to purchase two pairs of flexible supply lines and two 3/8" compression unions. The first pair must have a connector that fits your supply stop (usually 3/8" compression) and a 1/2" FIP connector at the opposing end to fit the control module's inlet port. The second pair, which will connect the control module to the 3/8" compression union, requires a 1/2" FIP connector at one end and a 3/8" compression connector at the opposing end. The 3/8" compression unions connect the second pair of supply lines to the faucet's inlet fittings.

Step 3 – Connecting the Water Lines

IMPORTANT:

The control module's inlet and outlet ports have 1/2" straight pipe threads. Straight pipe threads require fittings with gaskets or cone seals. **Never use thread sealants or Teflon tape with straight pipe thread connections.** The water seal is created by the gasket or the cone seal, not by the threads. All connections should be securely tightened against the seal. However, care should be taken to avoid over-tightening. Metal fittings can be hand-tightened and then turned an additional 1/4 to 1/2 turn with a tool.

- ① Close the supply stops and move the faucet handle(s) to the open position.
- ② Place a large towel under the work area to absorb any dripping water during the installation process.
- ③ Install the water connections according to Figure 1A or Figure 1B, as applicable.
- ④ Open the supply stops and check for leaks. Recheck for leaks after the foot pedal installation is complete.

Step 4 – Mounting the Control Module

The control module may be mounted to a horizontal or vertical surface using the two included mounting screws. Follow these steps to complete the installation:

- ① Position the control module against the mounting surface. Make sure the water lines are free of kinks and undue pressure.
- ② Mark the screw-hole locations with a pencil or a permanent marker by drawing against the inside edges of the screw holes.
- ③ Drill two 3/32" holes into the mounting surface.
- ④ Use a Phillips-head screw driver to tighten the screws.

Step 5 – Installing the Foot Pedal Wire

Figures 2A and 2B illustrate two different options for routing the foot pedal wire to the control module. The two options are described below:

Option A

Visible-Wire Foot Pedal Installation

The visible-wire installation method is the easiest method for installing the foot pedal. You will only need to drill one hole through the cabinet floor (refer to Figure 2A). Follow these steps to complete the installation:

- ① Drill a 1/2" hole through the cabinet floor as illustrated in Figure 2A. This hole must be in front of the toe-kick.
- ② Route the foot pedal wire through the hole.
- ③ Secure the wire in place with plastic wire staples (included) or pea-sized dots of hot glue.

Step 5 – Continued

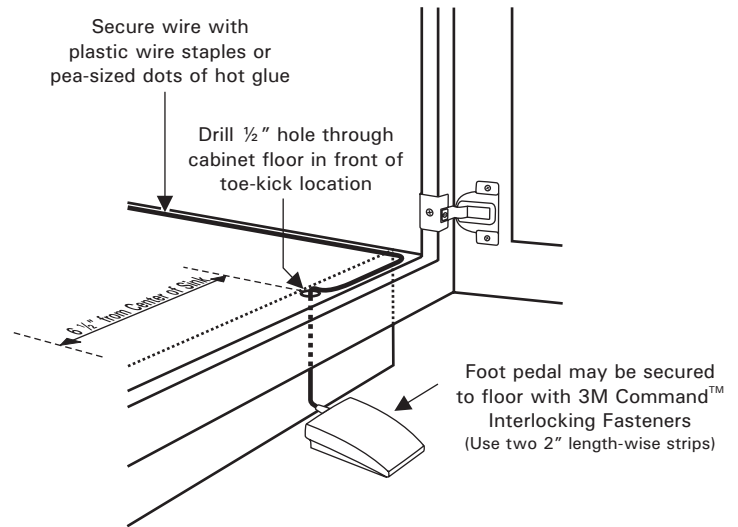

Figure 2A – Visible-Wire Foot Pedal Installation

Option B

Hidden-Wire Foot Pedal Installation

The hidden-wire installation method is more difficult than the visible-wire installation method. You must drill two holes into the cabinet as illustrated in Figure 2B. Feed the foot pedal wire through these holes using metal "fish-wire" (14 gauge solid-core electrical wire is ideal for this purpose). Follow these steps to complete the installation:

- ① Drill a 1/2" hole through the cabinet floor as shown in Figure 2A. This hole must be behind the toe-kick.
- ② Drill a second 1/2" hole through the toe-kick as shown in Figure 2A.
- ③ Route the "fish-wire" through both holes.
- ④ Attach the metal part of the foot pedal connector to the "fish-wire" with tape.
- ⑤ Using the "fish-wire," pull the foot pedal wire through the two holes.
- ⑥ Secure the wire in place with plastic wire staples (included) or pea-sized dots of hot glue.

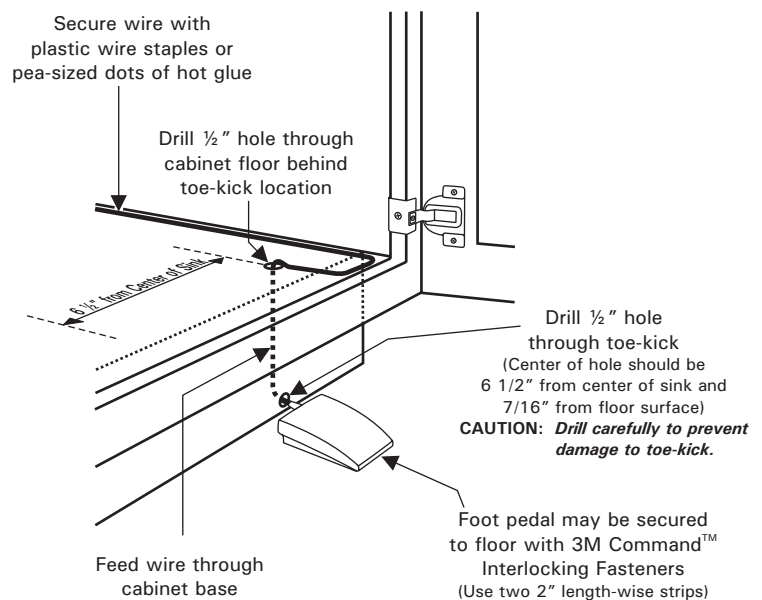

Figure 2B – Hidden-Wire Foot Pedal Installation

Step 6 – Attaching Foot Pedal to Floor (Optional)

If desired, secure the foot pedal to the floor surface with 3M Command™ Removable Interlocking Fasteners (available at most retail stores). Follow these steps to complete the installation:

- ① Clean the floor surface and the bottom of the foot pedal with isopropyl rubbing alcohol. Wipe gently and let dry.
- ② Attach two 2" 3M Command™ fastener strips length-wise to bottom of the foot pedal and two matching strips to the floor.
- ③ Apply firm pressure for 30 seconds and let dry for 1 hour for maximum strength.

Step 7 – Connecting the Power Supply

Only use the power supply included with your Faucet Control™. Follow these steps to connect the power supply:

- ① Connect the power supply cord to the power jack located in the lower right hand corner of the control module.
- ② Plug the power supply into a 110-Volt power receptacle.

WARNING:

Modifying your Faucet Control™ to remain continuously on may cause the power supply and the control module to overheat.

Operating Instructions

Operating your Faucet Control™ is easy. Just follow these steps:

- ① Select desired water flow rate and temperature with the faucet handle(s).
- ② Apply light pressure to the foot pedal to activate water flow.
- ③ Readjust flow rate and temperature as necessary using the faucet handle(s).
- ④ Release pressure from the foot pedal to stop water flow.

Note: Faucet Control™ will not function during power outages. Please use other faucets in your home until power is restored.

Unconditional 12-Month Warranty

If your Faucet Control™ fails to function properly for any reason, you may return it to EhcoTech LLC, postage paid, within 12 months of purchase. EhcoTech LLC will repair or replace the product and return it to you free of charge (within the United States only). If the original part cannot be repaired, or is no longer available, EhcoTech LLC will replace it with an equal or higher value part. Please include a short description of the problem, your return address, and proof of purchase with your shipment. Visit www.faucetcontrol.com for a printable warranty return form.

NOTE:

EhcoTech LLC shall not be liable for any incidental, consequential, or contingent damages or expenses arising, directly or indirectly, from a product defect or the use of the product. In addition, EhcoTech LLC shall not be liable for any water damage arising, directly or indirectly, from a product defect or the use of the product.

Repair and Parts

Information regarding repair service and replacement foot pedals is available at www.faucetcontrol.com.

Contact Information

EHCOTECHLLC

3196 Willow Creek Road
Suite A-103 #241
Prescott, AZ 86301

tel: 928.227.2865

fax: 928.277.1112

e-mail: info@faucetcontrol.com

www.faucetcontrol.com