

Package Content

Your Faucet Control™ Includes:

- Control Module
- Foot Pedal
- Mounting Screws (4)
- Quick-Splice Connectors (2)
- Installation and Operating Instructions

Compatibility

Faucet Control™ is compatible with all residential-style RV faucets with or without pullout sprayers, excluding infrared hands-free faucets.

Installation – General

Please read all instructions before attempting installation.

Supply lines and plumbing fittings are not included with your Faucet Control™ since the required lengths and diameters vary by installation. Fittings and supply lines are available at most home improvement and RV parts stores.

Step 1 – Determining Faucet Connection Type

Faucets can be divided into two general categories based on the size and type of the faucet inlet fittings. Use the following descriptions together with Figures 1A and 1B to determine the connection type:

Option A

Faucets with 1/2" Male Connectors

Most residential-style RV faucets have inlet ports with 1/2" male connectors. The outside diameter of 1/2" straight pipe male thread is 27/32" (the same as the control module's inlet and outlet ports).

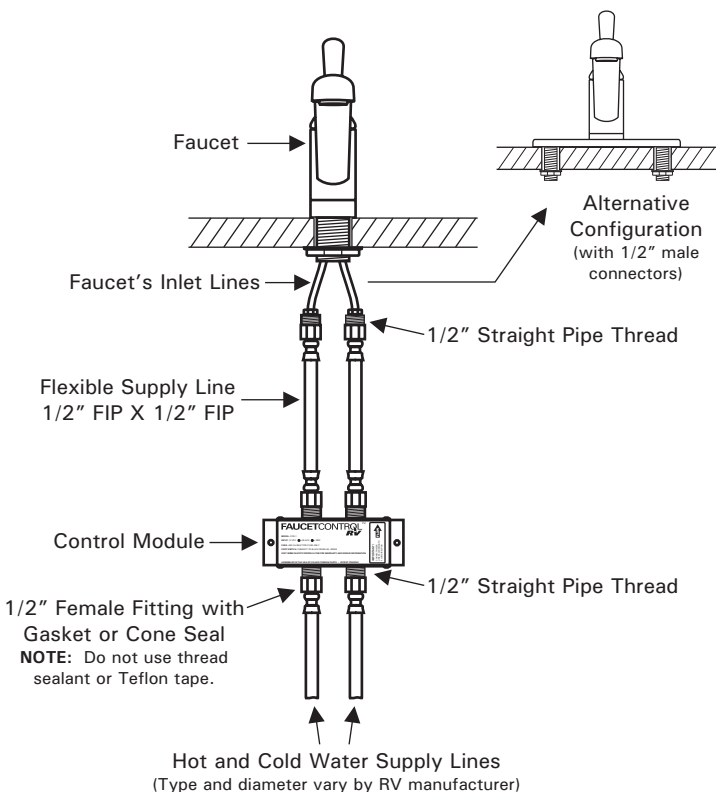

Figure 1A - Faucet with 1/2" Male Connectors

Step 1 – Continued

Option B

Faucets with 3/8" Female Compression Connectors

Some modern faucets come with integrated flexible inlet lines which have 3/8" female compression fittings. These flexible inlet lines are permanently connected to the faucet and have hex nut fittings with a typical head/wrench diameter of 5/8."

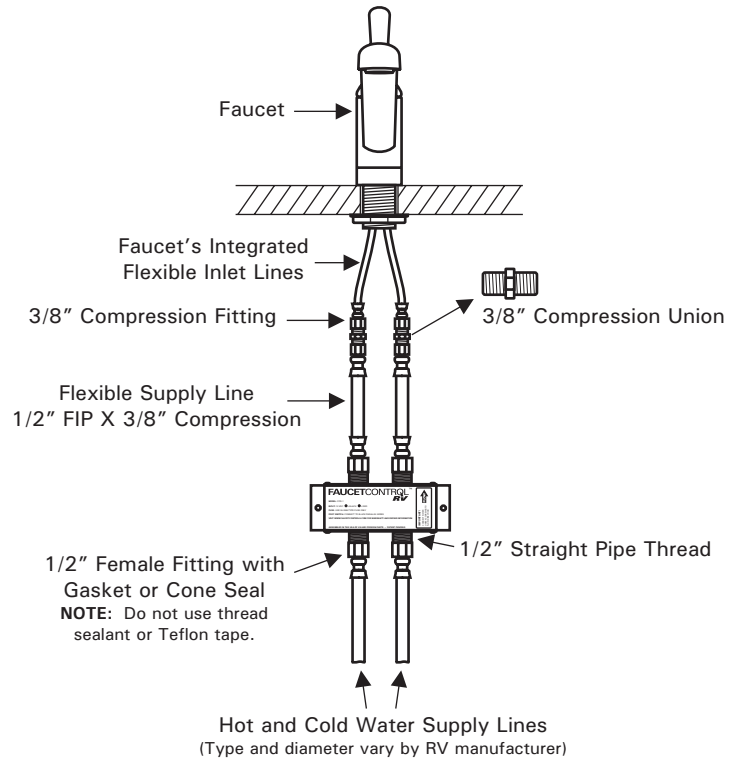

Figure 1B - Faucet with 3/8" Female Compression Connectors

Step 2 – Determining Supply Line/Fitting Needs

Option A

Faucets with 1/2" Male Connectors

If your current installation has **Flexible Supply Lines**, you may be able to disconnect them from your faucet and reconnect them to the control module's inlet ports. In this case, you will only need to purchase two flexible supply lines with 1/2" FIP connectors at both ends. These supply lines will connect the control module to your faucet.

If your fresh water is supplied through **Cross-Linked Polyethylene (PEX) Tubing** (going all the way to the faucet), you will need to shorten these lines. PEX tubing is generally milky-white colored, difficult to bend, and has a typical outside diameter of 1/2" or 5/8". These diameters equate to 3/8" and 1/2" inside diameters, respectively. Purchase two PEX fittings that match your PEX tubing diameter and have 1/2" female connectors with cone seals or gaskets for the control module's inlet ports. In addition, purchase two flexible supply lines with 1/2" FIP connectors at both ends. These supply lines will connect the control module's outlet ports to your faucet.

Step 2 – Determining Supply Line/Fitting Needs

Option B

Faucets with 3/8" Female Compression Connectors

You will need to purchase two fittings suitable for use with your water supply tubing (typically PEX tubing which can be recognized by its milky-white color). These fittings must match the diameter of your supply tubing and have 1/2" female connectors with cone seals or gaskets for the control module's inlet ports. In addition, purchase two flexible supply lines with a 1/2" FIP connector at one end and a 3/8" compression connector at the opposing end. These supply lines will connect the control module's outlet ports to the 3/8" compression union. Your faucet's flexible inlet lines will then connect to the 3/8" compression union.

Step 3 – Connecting the Water Lines

IMPORTANT:

The control module's inlet and outlet ports have 1/2" straight pipe threads. Straight pipe threads require fittings with gaskets or cone seals. **Never use thread sealants or Teflon tape with straight pipe thread connections.** The water seal is created by the gasket or the cone seal, not by the threads. All connections should be securely tightened against the seal. However, care should be taken to avoid over-tightening. Metal fittings can be hand-tightened and then turned an additional 1/4 to 1/2 turn with a tool.

- ① Turn the water pump switch off, disconnect any outside water sources, and move the faucet handle(s) to the open position.
- ② Place a large towel under the work area to absorb any dripping water during installation process.
- ③ Install the water connections according to Figure 1A or Figure 1B, as applicable.
- ④ Turn the water pump switch on (or connect to an external water source) and check for leaks. Recheck for leaks after the foot pedal installation is complete.

Step 4 – Mounting the Control Module

The control module may be mounted to a horizontal or vertical surface using the two included mounting screws. Follow these steps to complete the installation:

- ① Position the control module against the mounting surface. Make sure the water lines are free of kinks and undue pressure.
- ② Mark the screw-hole locations with a pencil or a permanent marker by drawing against the inside edges of the screw holes.
- ③ Drill two 3/32" holes into the mounting surface.
- ④ Use a Phillips-head screw driver to tighten the screws.

Step 5 – Installing the Foot Pedal Wire

NOTE:

If you purchased the optional foot pedal upgrade (Model FCP-1R), please refer to the instructions sheet specific to that pedal.

Two different options for routing the foot pedal wire are described in this installation manual. These two options only work with standard RV cabinets. In RVs with non-standard cabinet configurations the installer must determine the most appropriate installation method.

Step 5 – Continued

Option A

Visible-Wire Foot Pedal Installation

The visible-wire installation method is the easiest method for installing the foot pedal. You will need to drill only one hole through the cabinet floor (refer to Figure 2A).

NOTE:

This method can only be used with cabinets that have toe-spaces. For cabinets without a toe-space, use the hidden wire installation method.

Follow these steps to complete the installation:

- ① Drill a 1/4" hole through the cabinet floor as illustrated in Figure 2A. This hole must be in front of the toe-kick.
- ② Feed the foot pedal wire through the hole.
- ③ Secure the wire in place with pea-sized dots of hot glue starting from the control unit (excess wire will be trimmed off at the foot pedal end).
- ④ Trim the foot pedal wire to the appropriate length, making sure it will reach the two metal connectors located on the bottom of foot pedal.
- ⑤ Remove approximately 3/16" of insulation from both black wires.
- ⑥ Connect the wires to the foot pedal's metal connectors.
- ⑧ Remove the top part of the pedal from the pedal base by pulling directly upward.
- ⑧ Position the foot pedal in the final mounting location and drill two 3/32" holes into the floor using the pedal as a guide.
- ⑩ Secure the pedal to the floor with two included screws (#6 X 1 1/4") and reattach the top part of the pedal.

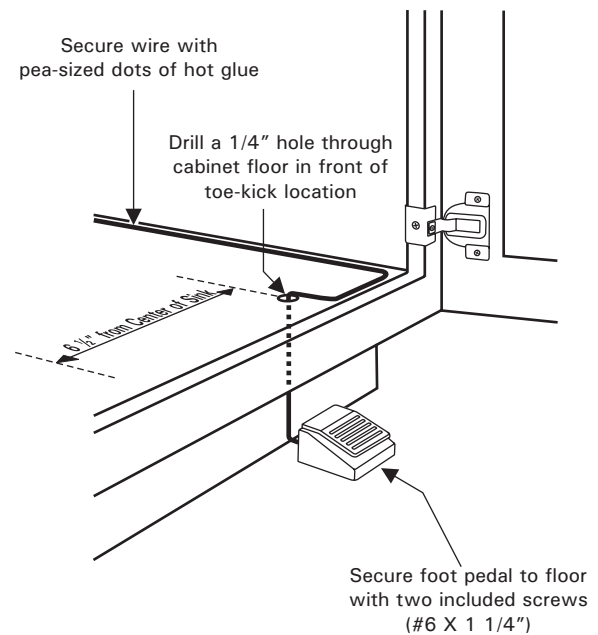

NOTE: This illustration shows a cabinet with a toe-space. For cabinets without a toe-space, use the hidden-wire installation method shown in Figure 2B.

Figure 2A – Visible-Wire Foot Pedal Installation

Step 5 – Continued

Option B

Hidden-Wire Foot Pedal Installation

The hidden-wire installation method is more difficult than the visible-wire installation method. You must drill two holes into the cabinet as illustrated in Figure 2B. Feed the foot pedal wire through these holes using metal “fish-wire” (14 gauge solid-core electrical wire is ideal for this purpose). Follow these steps to complete the installation:

- ① Drill a 1/4" hole through the cabinet floor (behind the toe-kick) and a second 1/4" hole through the toe-kick as shown in Figure 2A.
- ② Feed the wire through these holes using a “fish-wire”
- ③ Secure the wire in place with pea-sized dots of hot glue starting from the control unit (excess wire will be trimmed off at the foot pedal end).
- ④ Trim the foot pedal wire to the appropriate length, making sure it will reach the two metal connectors located on the bottom of foot pedal.
- ⑤ Remove 3/16" of insulation from both black wires.
- ⑥ Connect the wires to the foot pedal’s metal connectors.
- ⑦ Remove the top part of the pedal from the pedal base by pulling directly upward.
- ⑧ Position the foot pedal in the final mounting location and drill two 3/32" holes into the floor using the pedal as a guide.
- ⑨ Secure the pedal to the floor with two included screws (#6 X 1 1/4") and reattach the top part of the pedal base.

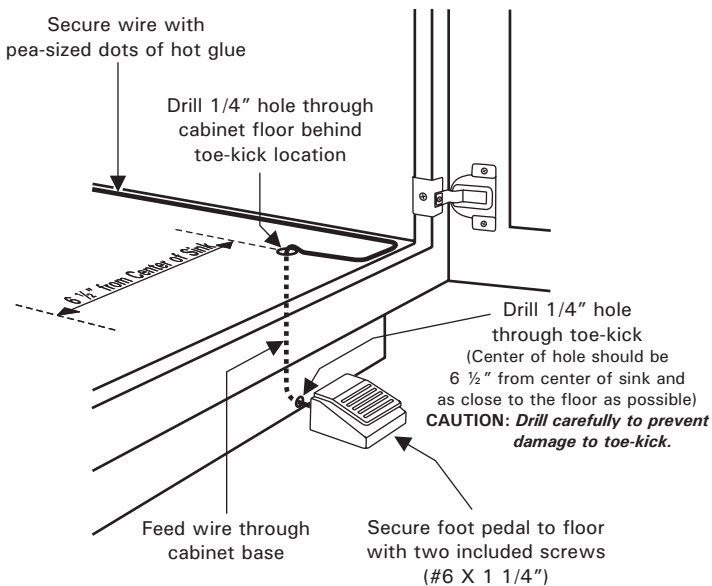

Figure 2B – Hidden-Wire Foot Pedal Installation

Step 6 – Connecting Electrical Wires

The control module is powered by the RV’s 12 VDC electrical system. Please follow these guidelines when making the electrical connections:

- If a dedicated 3-amp circuit is not available, the control module can be piggy-backed from an existing circuit since the control module’s amperage draw is low (less than 1 amp).

Step 6 – Continued

- Two quick-splice connectors are included for connecting the power wires to an existing circuit.
- Make sure the circuit has capacity for the additional load.
- **Never replace a fuse with a higher amperage fuse** in an attempt to increase the load capacity of the electrical circuit.
- If necessary, you may extend the control module’s power wires with 18 gauge or thicker wire.
- **Disconnect the battery and any external 110-volt power connection before installation.**

Reference the following table to ensure proper polarity when connecting the control module:

POLARITY CHART	POSITIVE	NEGATIVE
Control Module	Red Wire	Black Wire
Typical RV Electrical System	Black Wire	White Wire

WARNING:

Modifying your Faucet Control™ to remain continuously on may cause the control module to overheat.

Operating Instructions

Operating your Faucet Control™ is easy. Just follow these steps:

- ① Select desired water flow rate and temperature with the faucet handle(s).
- ② Apply light pressure to the foot pedal to activate water flow.
- ③ Readjust flow rate and temperature as necessary using the faucet handle(s).
- ④ Release pressure from the foot pedal to stop water flow.

Winterizing the Freshwater System

Winterize the freshwater system in a normal manner. Make sure to open both hot and cold water flow with your faucet handle(s). Then press the foot pedal until antifreeze liquid flows through the faucet and replaces all water in the P-trap under the sink.

Repair and Parts

Information regarding repair service and replacement foot pedals is available at www.faucetcontrol.com.

Unconditional 12-Month Warranty

If your Faucet Control™ fails to function properly for any reason, you may return it to EhcoTech LLC, postage paid, within 12 months of purchase. EhcoTech LLC will repair or replace the product and return it to you free of charge (within the United States only). If the original part cannot be repaired, or is no longer available, EhcoTech LLC will replace it with an equal or higher value part. Visit www.faucetcontrol.com for a printable warranty return form.

NOTE:

EhcoTech LLC shall not be liable for any incidental, consequential, or contingent damages or expenses arising, directly or indirectly, from a product defect or the use of the product. In addition, EhcoTech LLC shall not be liable for any water damage arising, directly or indirectly, from a product defect or the use of the product.

EHCOTECH_{LLC}

3196 Willow Creek Road
Suite A-103 #241
Prescott, AZ 86301
tel: 928.227.2865
fax: 928.277.1112

e-mail: info@faucetcontrol.com
www.faucetcontrol.com